

140-1000

BANBALK SERIE 140
CONVEYOR BEAM SERIE 140
FÜHRUNGSPROFIL SERIE 140

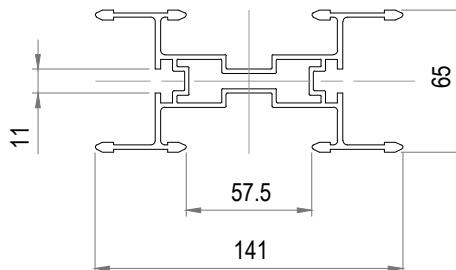

140-1010

KURVBALK SERIE 140
HALF BEAM SERIE 140
HALBES FÜHRUNGSPROFIL SERIE 140

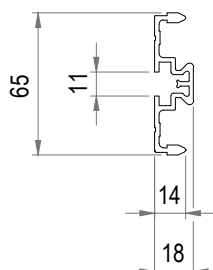

140-1015

BREDDNINGSLIST SERIE 140
BEAM EXTENSION SERIE 140
BREITEPROFIL SERIE 140

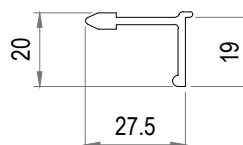

140-1020

BANBALK ÖPPEN SERIE 140
CONVEYOR BEAM OPEN SERIE 140
FÜHRUNGSPROFIL OFFEN SERIE 140

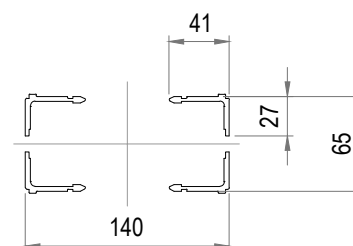

140-1025

BREDDLISTFÄSTE
BEAM EXTENSION CLAMP
BREITEPROFILBEFESTIGUNG

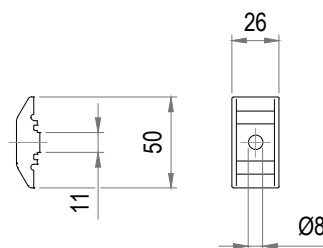

140-1030

KLAMMA FÖR KURVBALK
CLAMP FOR HALF BEAM
KLAMMER FÜR HALBES FÜHRUNGSPROFIL

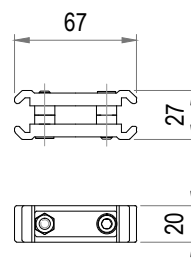

140-1040

DISTANS ÖPPEN PROFIL
SPACER OPEN PROFILE
DISTANZ OFFEN PROFIL

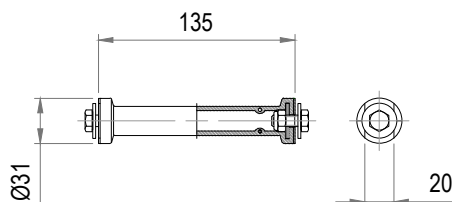

140-1050

LISTFÄSTE ÖPPEN PROFIL
STRIP ATTACHEMENT OPEN PROFILE
VERBINDUNGSSTÜCK OFFEN PROFIL

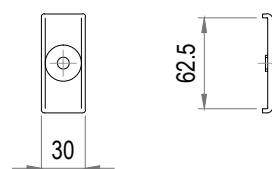

KEDJOR

FÖR ANNAT KEDJEMATERIAL ÄN STANDARD VIT ACETAL ANGES TILLÄGGSBOSKTAV

L = LÄGFRIKTION

V = VÄRMEBESTÄNDIG

A = ANTISTATISK

F = FLOCKAD

BESTÄLLNINGSEXEMPEL 140-2000L

CHAINS

FOR OTHER CHAINS MATERIAL THAN STANDARD WHITE ACETAL ADD LETTER

L = LOW FRICTION

V = HEAT RESISTENT

A = ANTISTATIC

F = FLOCKED

ORDER EXEMPEL 140-2000L

KETTEN

AUS ANDEREN VOM STANDARD ACETAL ABWEICHENDEN MATERIALEN

L = GERINGE FRIKTION

V = WÄRMEBESTÄNDIGKEIT

A = ANTISTATISCH

F = BEFLOCKT

BESTÄLLBEISPIEL 140-2000L

140-2000

FINGERKEDJA FÖR SERIE 140 OCH 540
FINGER CHAIN FOR SERIE 140 AND 540
FINGERKETTE FÜR SERIE 140 UND 540

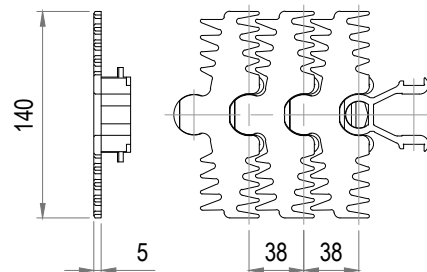

140-2005

DELTAKEDJA FÖR SERIE 140 OCH 540
DELTA CHAIN FOR SERIE 140 AND 540
DELTAKETTE FÜR SERIE 140 UND 540

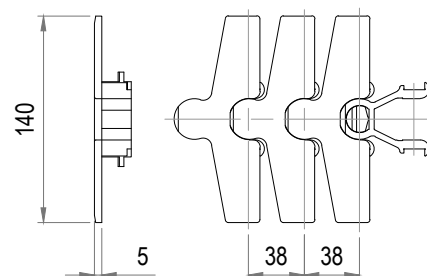

140-2010

FRIKTIONSKEDJA FÖR SERIE 140 OCH 540
FRICTION CHAIN FOR SERIE 140 AND 540
FRIKTIONSKETTE FÜR SERIE 140 UND 540

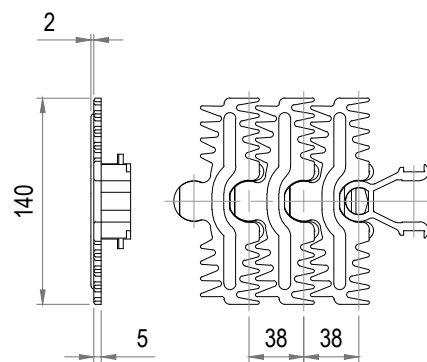

140-2020

FRIKTIONSKEDJA FÖR SERIE 140 OCH 540
FRICTION CHAIN FOR SERIE 140 AND 540
FRIKTIONSKETTE FÜR SERIE 140 UND 540

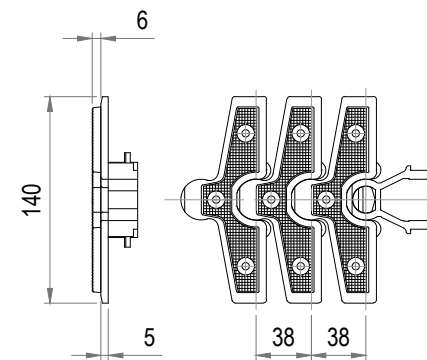

140-2075

LOCK FÖR MEDBRINGARE SERIE 140 OCH 540
TOPFLIGHT FOR CARRIER SERIE 140 AND 540
KOPFPLATTE FÜR MITNEHMER SERIE 140 UND 540

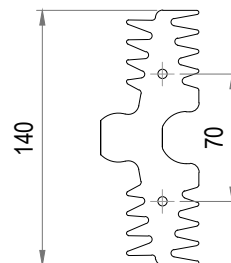

140-2078

MEDBRINGARE MED RULLE
CARRIER WITH ROLLER
MITNEHMER MIT ROLLE

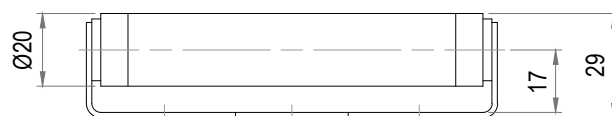
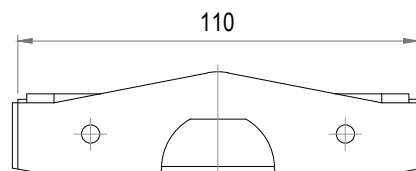

140-2079

LOCK MED RULLMEDBRINGARE SERIE 140 AND 540
TOPFLIGHT WITH ROLLERCARRIER SERIE 140 AND 540
KOPFPLATTE MIT ROLLEMITNEHMER SERIE 140 AND 540

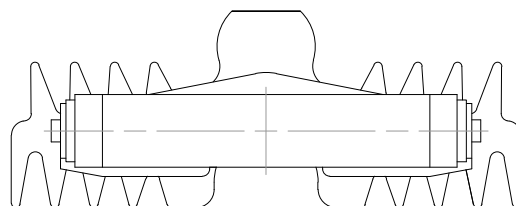
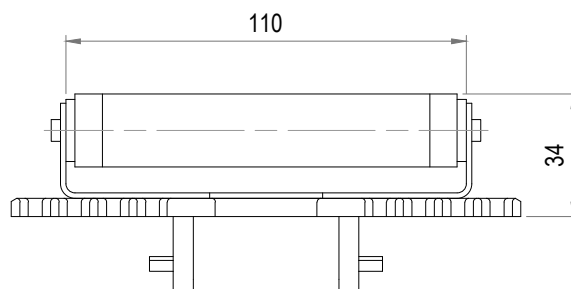

140-2080

MEDBRINGARE
CARRIER
MITNEHMER

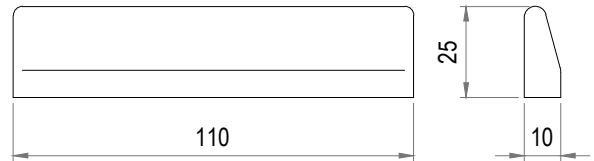

140-2081

LOCK MED MEDBRINGARE SERIE 140 OCH 540
TOPFLIGHT WITH CARRIER SERIE 140 AND 540
KOPFPLATTE MIT MITNEHMER SERIE 140 UND 540

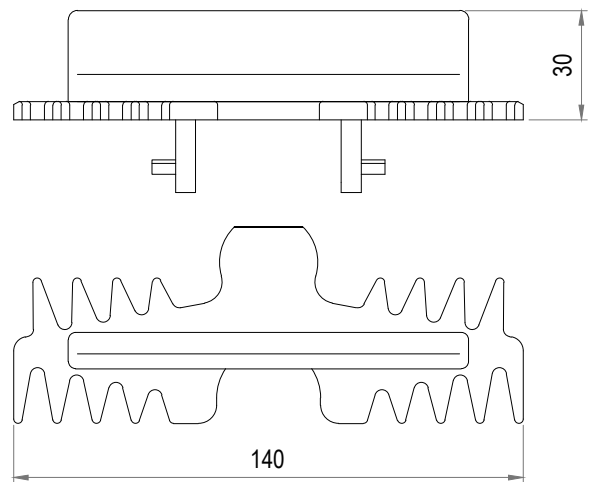

140-2090

DISTANSBRICKA FÖR MEDBRINGARE 140-2080
SPACER FOR CARRIER 140-2080
DISTANZ FÜR MITNEHMER 140-2080

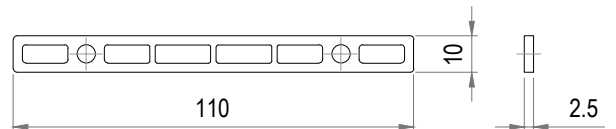

140-2110

KLÄMKEDJA SERIE 140 OCH 540
SIDE GRIP CHAIN SERIE 140 AND 540
KETTE KLEMMTRANSPORT SERIE 140 UND 540

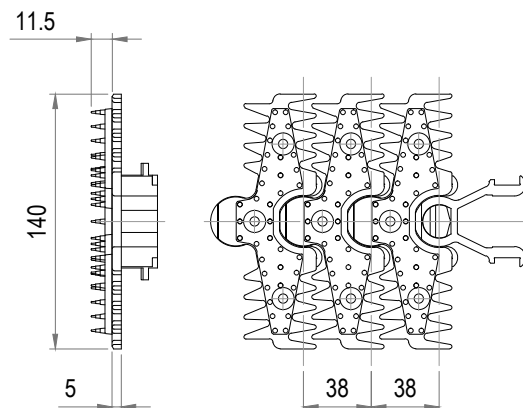

140-2175

LOCK FÖR MEDBRINGARE SERIE 140 OCH 540
TOPFLIGHT FOR CARRIER SERIE 140 AND 540
KOPFPLATTE FÜR MITNEHMER SERIE 140 UND 540

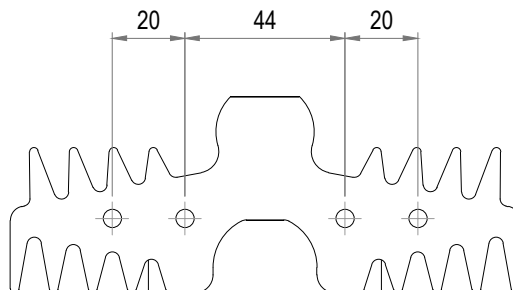

140-2178

MEDBRINGARE FÖR 140-2175
CARRIER FOR 140-2175
MITNEHMER FÜR 140-2175

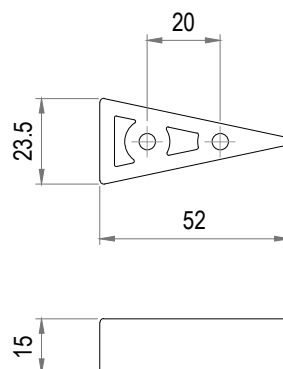

140-2179

LOCK MED MEDBRINGARE SERIE 140 OCH 540
TOPFLIGHT WITH CARRIER SERIE 140 AND 540
KOPFPLATTE MIT MITNEHMER SERIE 140 UND 540

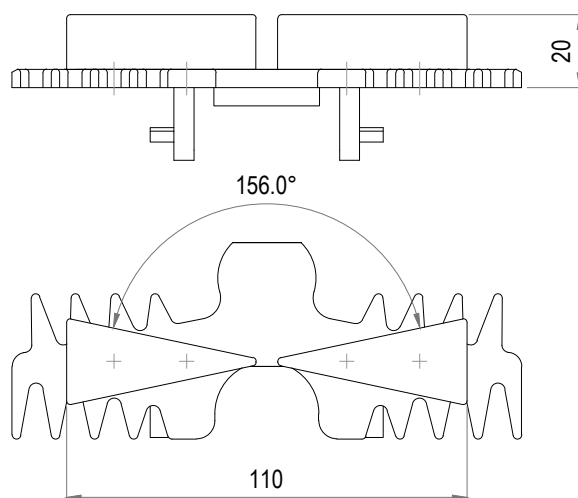

140-310V/H

DRIVSTATION MED ABB/BENZLER SERIE 140
DRIVE UNIT WITH ABB/BENZLER SERIE 140
ANTRIEBSSTATION MIT ABB/BENZLER SERIE 140

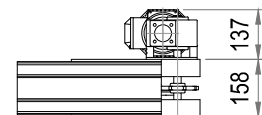
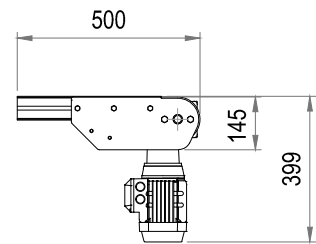

140-315V/H

DRIVSTATION MED ABB/BENZLER SERIE 140
DRIVE UNIT WITH ABB/BENZLER SERIE 140
ANTRIEBSSTATION MIT ABB/BENZLER SERIE 140

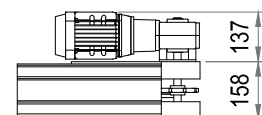
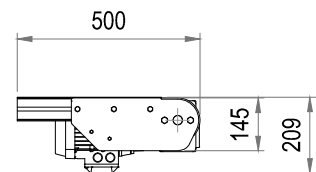

140-324V/H

DRIVSTATION MED UNDERHÄNGANDE DRIFT SERIE 140
DRIVE UNIT WITH SUSPENDED GEARBOX SERIE 140
ANTRIEBSSTATION MIT UNTENLIEGENDEM GETRIEBE SERIE 140

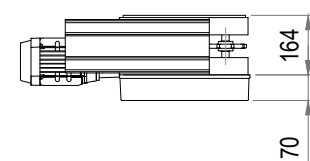
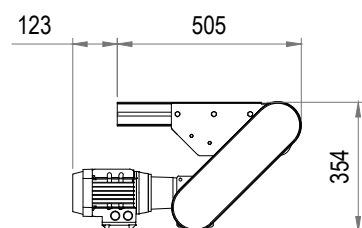

140-325V/H

DRIVSTATION FÖRBEREDD FÖR UNDERHÄNGANDE VÄXELLÅDA SERIE 140
DRIVE UNIT PREPARED FOR SUSPENDED GEARBOX SERIE 140
ANTRIEBSSTATION VORBEREITET FÜR UNTENLIEGENDEM GETRIEBE SERIE 140

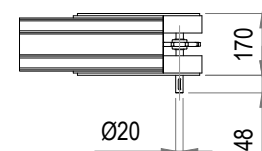
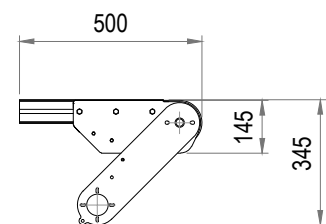

140-330V/H

MITTDRIV MED RETURKEDJA SERIE 140
INTERMEDIATE DRIVE SERIE 140
MITTELANTRIEB SERIE 140

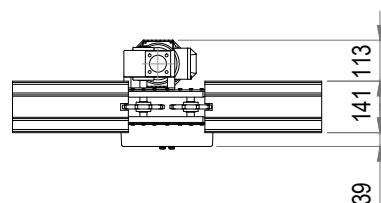
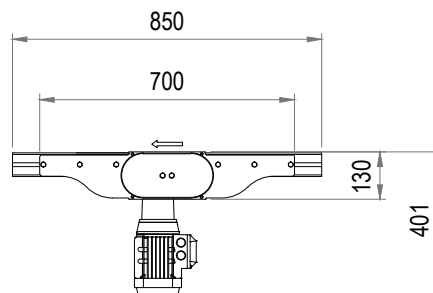

140-335V/H

DRIVSTATION, DRIFT PÅ VÄNSTER/HÖGER SIDA SERIE 140
DRIVE UNIT, TRANSMISSION ON LEFT/RIGHT HAND SIDE SERIE 140
ANTRIEBSSTATION, GETRIBE AUF LINKER/RECHT SEITE SERIE 140

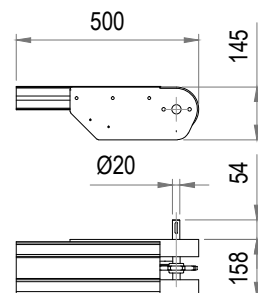

140-345V/H

DRIVSTATION RUNDGÅENDE TRANSPORTÖR SERIE 140
CATENARY DRIVE UNIT SERIE 140
ANTRIEBSSTATION FÜR RUNDGANG SERIE 140

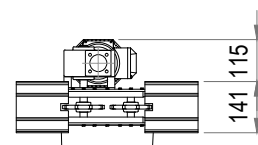
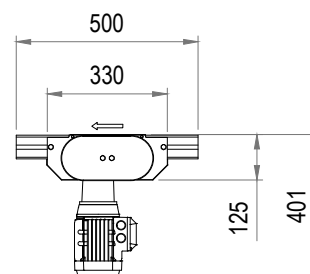

140-350V/H

DRIVSTATION MED SEW SA37 SERIE 140
DRIVE UNIT WITH SEW SA37 SERIE 140
ANTRIEBSSTATION MIT SEW SA37 SERIE 140

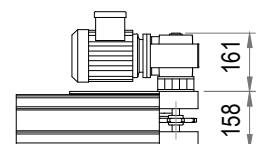
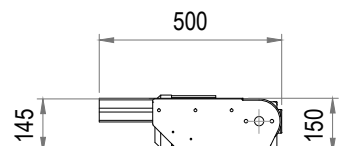

140-355V/H

DRIVSTATION MED SEW SA37 SERIE 140
DRIVE UNIT WITH SEW SA37 SERIE 140
ANTRIEBSSTATION MIT SEW SA37 SERIE 140

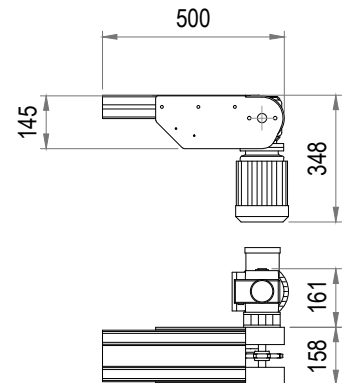

140-360V/H

DRIVSTATION MED SEW WA20 SERIE 140
DRIVE UNIT WITH SEW WA20 SERIE 140
ANTRIEBSSTATION MIT SEW WA20 SERIE 140

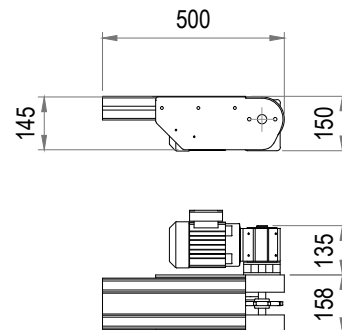

140-365V/H

DRIVSTATION MED SEW WA20 SERIE 140
DRIVE UNIT WITH SEW WA20 SERIE 140
ANTRIEBSSTATION MIT SEW WA20 SERIE 140

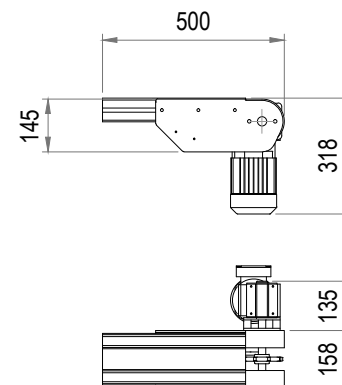

140-370V/H

DRIVSTATION MED SEW WA30 SERIE 140
DRIVE UNIT WITH SEW WA30 SERIE 140
ANTRIEBSSTATION MIT SEW WA30 SERIE 140

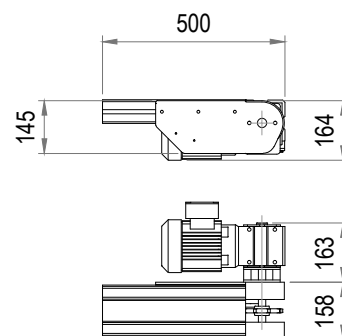

140-375V/H

DRIVSTATION MED SEW WA30 SERIE 140
DRIVE UNIT WITH SEW WA30 SERIE 140
ANTRIEBSSTATION MIT SEW WA30 SERIE 140

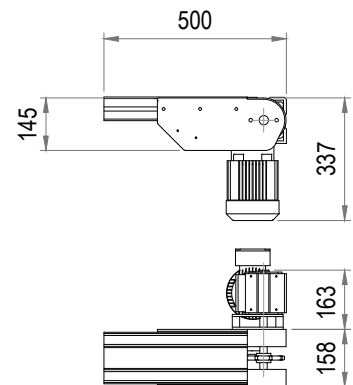

140-4000

VÄNDENHET SERIE 140
IDLER UNIT SERIE 140
UMLLENKEINHEIT SERIE 140

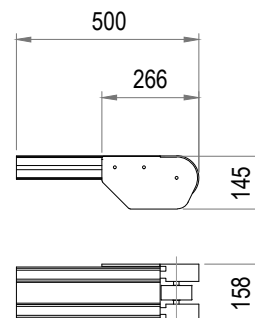

140-4040

VÄNDENHET 90° SERIE 140
IDLER UNIT 90° SERIE 140
UMLLENKEINHEIT 90° SERIE 140

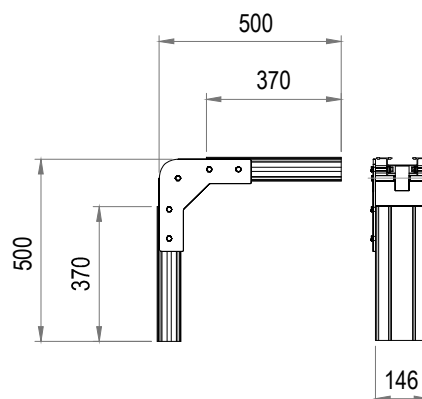

140-4050

VÄNDENHET FÖR DRIVENHET 140-330V/H SERIE 140
IDLER UNIT FOR DRIVE UNIT 140-330V/H SERIE 140
UMLLENKEINHEIT FÜR ANTRIEB 140-330V/H SERIE 140

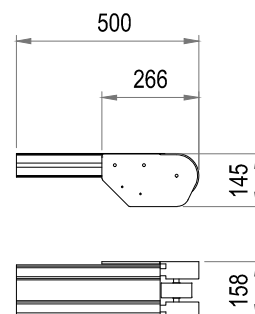

140-5035

HJULKURVA 45° SERIE 140
WHEELCURVE 45° SERIE 140
RADBOGEN 45° SERIE 140

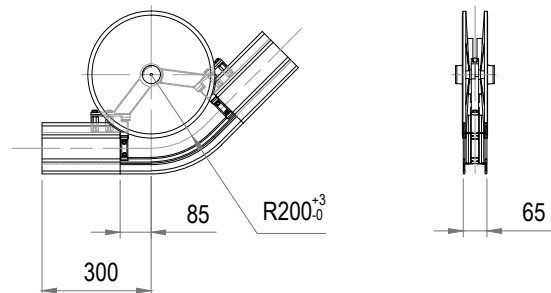

140-5040

HJULKURVA 90° SERIE 140
WHEELCURVE 90° SERIE 140
RADBOGEN 90° SERIE 140

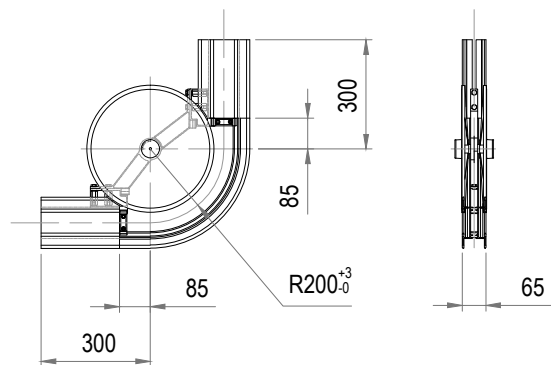

140-5050

HJULKURVA 180° SERIE 140
WHEELCURVE 180° SERIE 140
RADBOGEN 180° SERIE 140

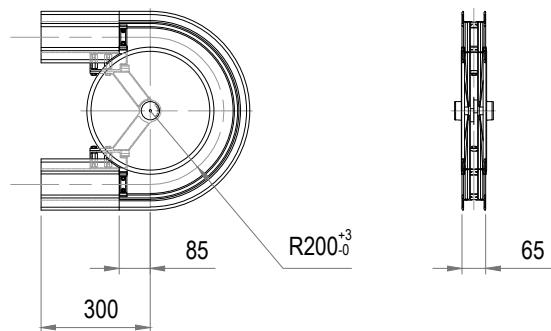

140-5055

HJULKURVA X° SERIE 140
WHEELCURVE X° SERIE 140
RADBOGEN X° SERIE 140

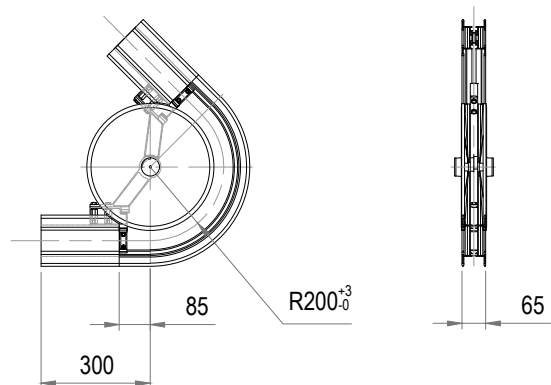

140-5056

KURVSTATIV FÖR HJULKURVA R200 SERIE 140
ADJUSTABLE SUPPORT ASSEMBLY R200 SERIE 140
LAGERSTREBEN FÜR RADBOGEN R200 SERIE 140

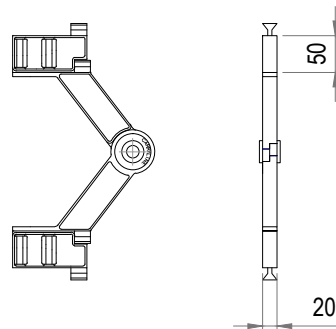

140-5057

DISTANSKLOSS TILL KURVSTATIV
SPACING BLOCK FOR ADJUSTABLE SUPPORT
ABSTANDHALTER FÜR LAGERSTREBEN

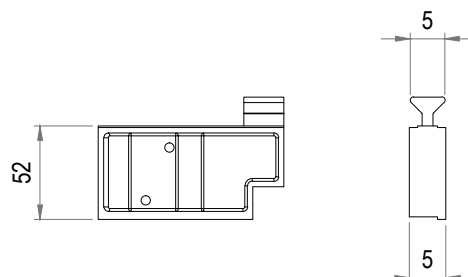

140-5058

AXEL TILL HJULKURVA R200
SHAFT FOR WHEELCURVE R200
WELLE FÜR RADBOGEN R200

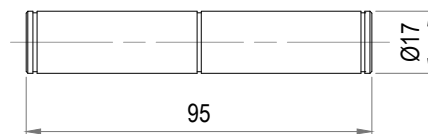

140-5059

KLÄMSKYDD FÖR HJULKURVA R200
PINCH GUARD FOR WHEELCURVE R200
KLEMMABDECKUNG FÜR RADBOGEN R200

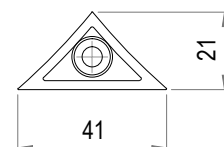

140-5060

TALLRIK TILL HJULKURVA R200
WHEELCURVE DISC R200
TELLER FÜR RADBOGEN R200

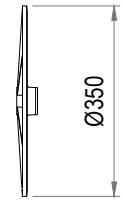
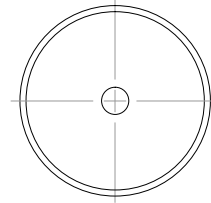

140-5062

PLASTKÅPA FÖR TALLRIK R200 SERIE 140
PLASTIC COVER FOR WHEEL CURVE DISC R200 SERIE 140
KUNSTGLASWANNE FÜR TELLER R200 SERIE 140

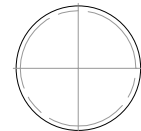
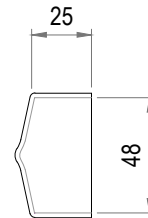

140-5180

GLIDKURVA 15° SERIE 140
PLAIN BEND 15° SERIE 140
GLEITBOGEN 15° SERIE 140

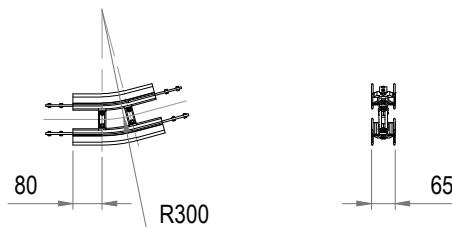

140-5190

GLIDKURVA 30° SERIE 140
PLAIN BEND 30° SERIE 140
GLEITBOGEN 30° SERIE 140

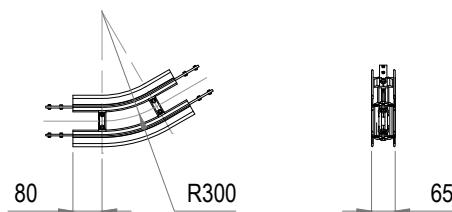

140-5200

GLIDKURVA 45° SERIE 140
PLAIN BEND 45° SERIE 140
GLEITBOGEN 45° SERIE 140

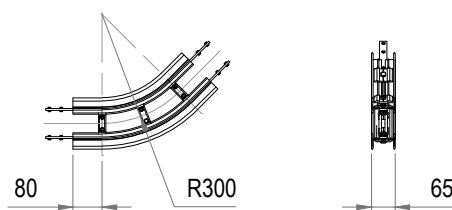

140-5210

GLIDKURVA 90° SERIE 140
PLAIN BEND 90° SERIE 140
GLEITBOGEN 90° SERIE 140

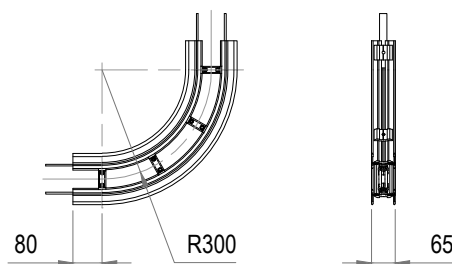

140-5220

GLIDKURVA 180° SERIE 140
PLAIN BEND 180° SERIE 140
GLEITBOGEN 180° SERIE 140

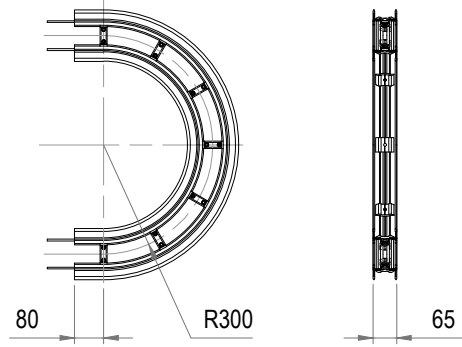

140-5230

GLIDKURVA 15° SERIE 140
PLAIN BEND 15° SERIE 140
GLEITBOGEN 15° SERIE 140

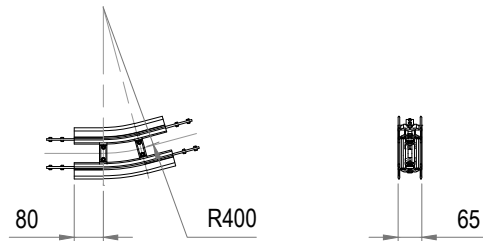

140-5240

GLIDKURVA 30° SERIE 140
PLAIN BEND 30° SERIE 140
GLEITBOGEN 30° SERIE 140

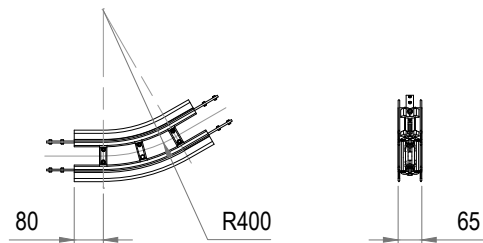

140-5250

GLIDKURVA 45° SERIE 140
PLAIN BEND 45° SERIE 140
GLEITBOGEN 45° SERIE 140

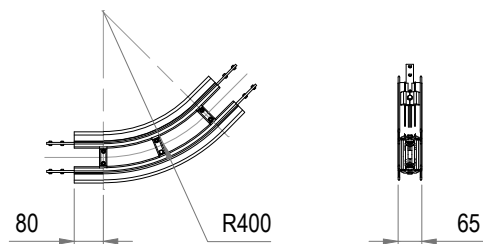

140-5260

GLIDKURVA 90° SERIE 140
PLAIN BEND 90° SERIE 140
GLEITBOGEN 90° SERIE 140

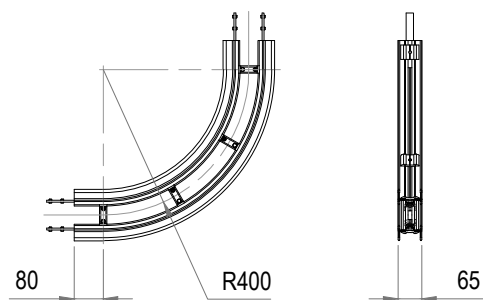

140-5270

GLIDKURVA 180° SERIE 140
PLAIN BEND 180° SERIE 140
GLEITBOGEN 180° SERIE 140

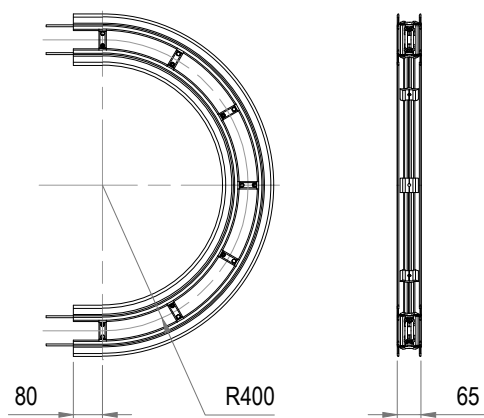

140-5280

GLIDKURVA 15° SERIE 140
PLAIN BEND 15° SERIE 140
GLEITBOGEN 15° SERIE 140

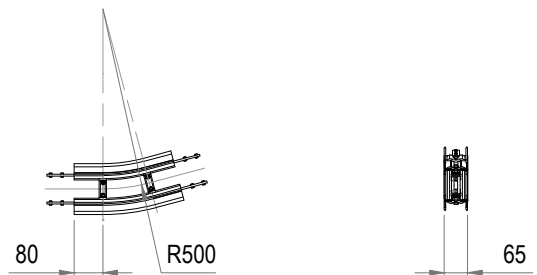

140-5290

GLIDKURVA 30° SERIE 140
PLAIN BEND 30° SERIE 140
GLEITBOGEN 30° SERIE 140

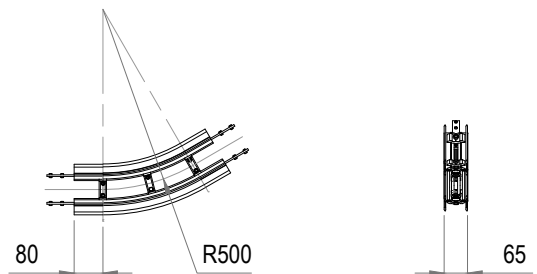

140-5300

GLIDKURVA 45° SERIE 140
PLAIN BEND 45° SERIE 140
GLEITBOGEN 45° SERIE 140

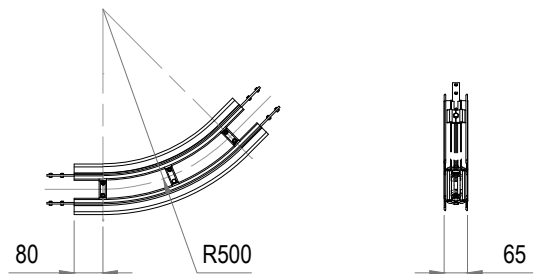

140-5310

GLIDKURVA 90° SERIE 140
PLAIN BEND 90° SERIE 140
GLEITBOGEN 90° SERIE 140

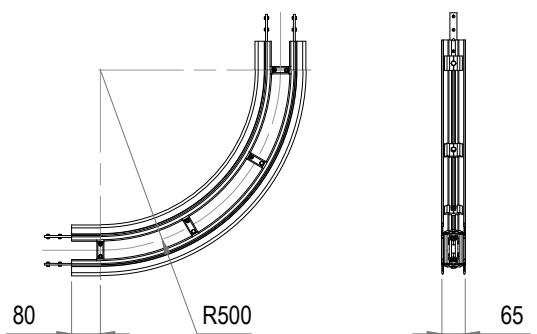

140-5320

GLIDKURVA 180° SERIE 140
PLAIN BEND 180° SERIE 140
GLEITBOGEN 180° SERIE 140

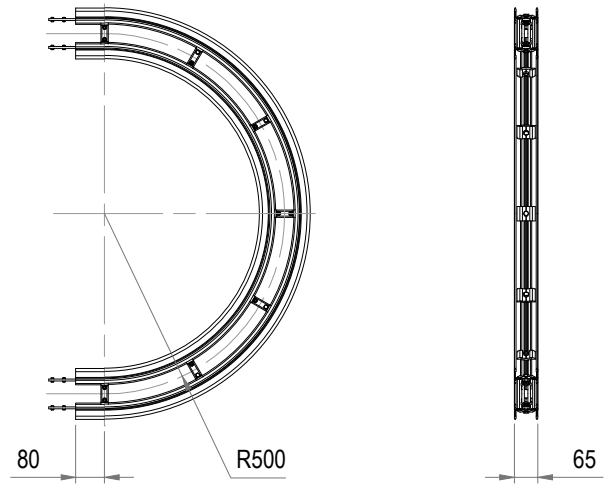

140-5330

GLIDKURVA 15° SERIE 140
PLAIN BEND 15° SERIE 140
GLEITBOGEN 15° SERIE 140

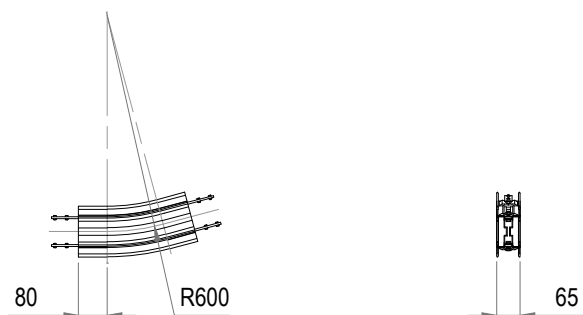

140-5340

GLIDKURVA 30° SERIE 140
PLAIN BEND 30° SERIE 140
GLEITBOGEN 30° SERIE 140

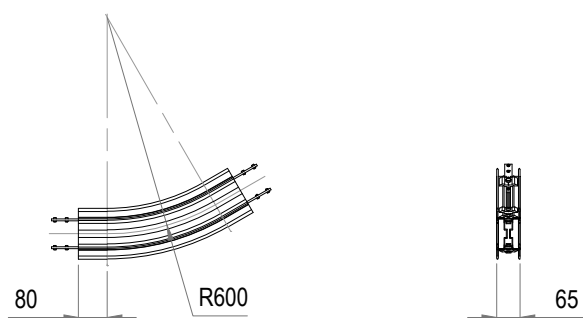

140-5350

GLIDKURVA 45° SERIE 140
PLAIN BEND 45° SERIE 140
GLEITBOGEN 45° SERIE 140

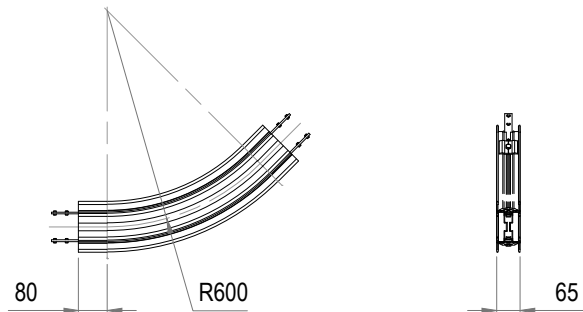

140-5360

GLIDKURVA 90° SERIE 140
PLAIN BEND 90° SERIE 140
GLEITBOGEN 90° SERIE 140

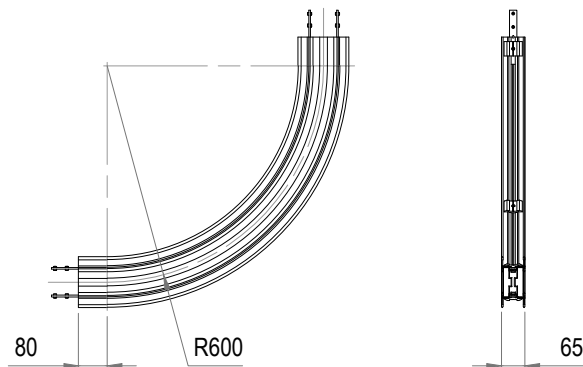

140-5370

GLIDKURVA 180° SERIE 140
PLAIN BEND 180° SERIE 140
GLEITBOGEN 180° SERIE 140

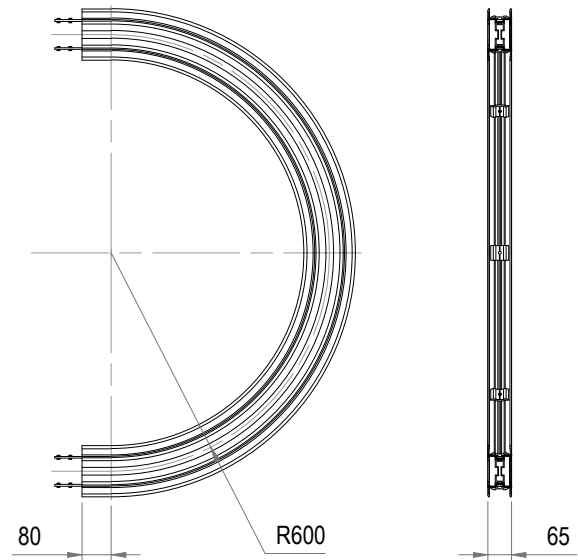

140-5375

GLIDKURVA X° SERIE 140
PLAIN BEND X° SERIE 140
GLEITBOGEN X° SERIE 140

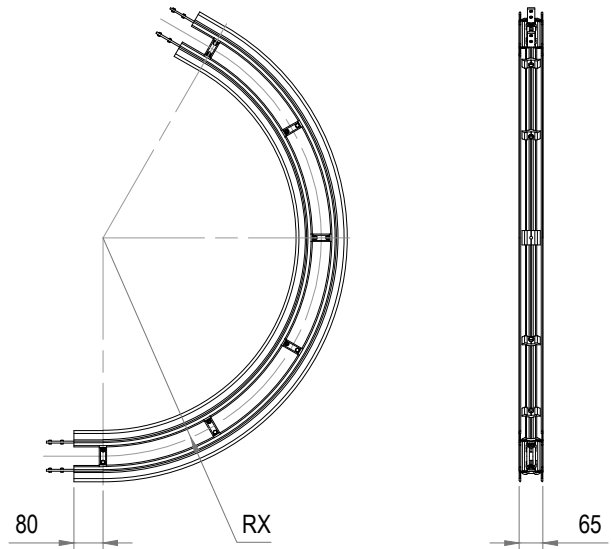

140-5610

VERTIKALKURVA 30° SERIE 140
VERTICAL BEND 30° SERIE 140
VERTIKALBOGEN 30° SERIE 140

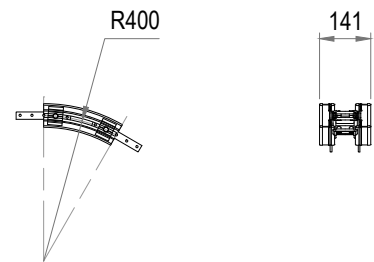

140-5620

VERTIKALKURVA 45° SERIE 140
VERTICAL BEND 45° SERIE 140
VERTIKALBOGEN 45° SERIE 140

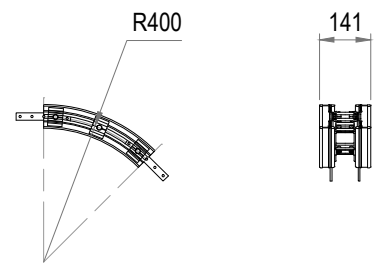

140-5630

VERTIKALKURVA 60° SERIE 140
VERTICAL BEND 60° SERIE 140
VERTIKALBOGEN 60° SERIE 140

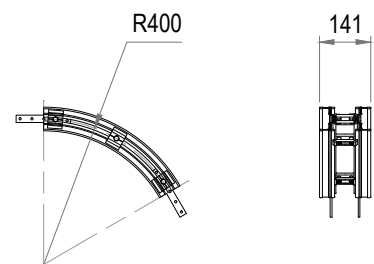

140-5640

VERTIKALKURVA 90° SERIE 140
VERTICAL BEND 90° SERIE 140
VERTIKALBOGEN 90° SERIE 140

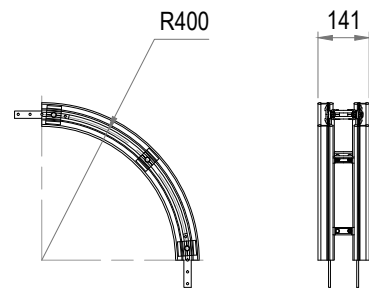

140-5645

VERTIKALKURVA X° (MIN 10°) SERIE 140
VERTICAL BEND X° (MIN 10°) SERIE 140
VERTIKALBOGEN X° (MIN 10°) SERIE 140

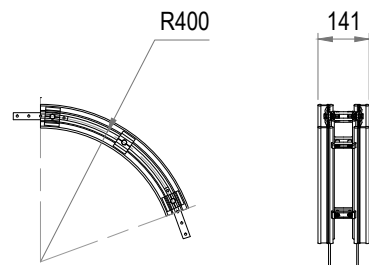

140-5650

VERTIKALKURVA 5° SERIE 140
VERTICAL BEND 5° SERIE 140
VERTIKALBOGEN 5° SERIE 140

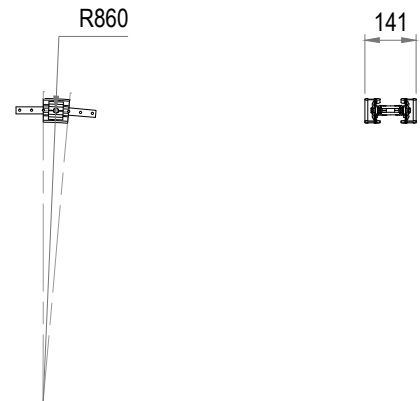

140-5660

VERTIKALKURVA 30° SERIE 140
VERTICAL BEND 30° SERIE 140
VERTIKALBOGEN 30° SERIE 140

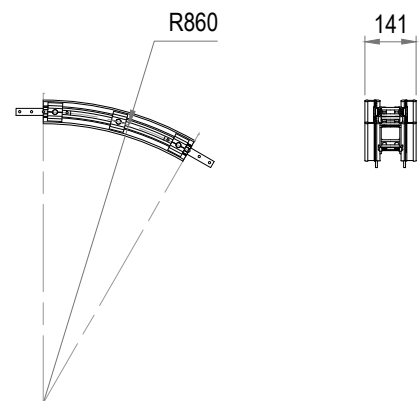

140-5670

VERTIKALKURVA 45° SERIE 140
VERTICAL BEND 45° SERIE 140
VERTIKALBOGEN 45° SERIE 140

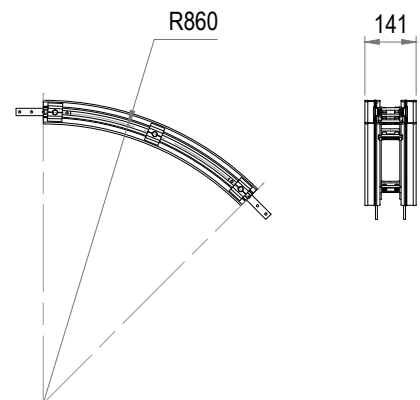

140-5680

VERTIKALKURVA 60° SERIE 140
VERTICAL BEND 60° SERIE 140
VERTIKALBOGEN 60° SERIE 140

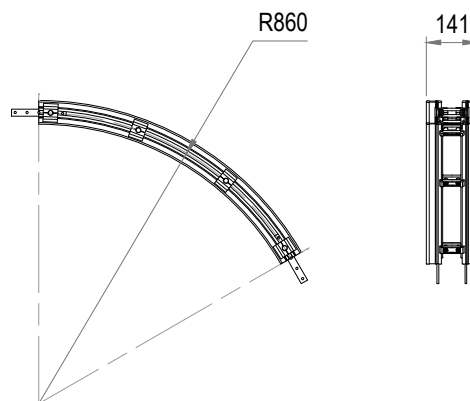

140-5690

VERTIKALKURVA 90° SERIE 140
VERTICAL BEND 90° SERIE 140
VERTIKALBOGEN 90° SERIE 140

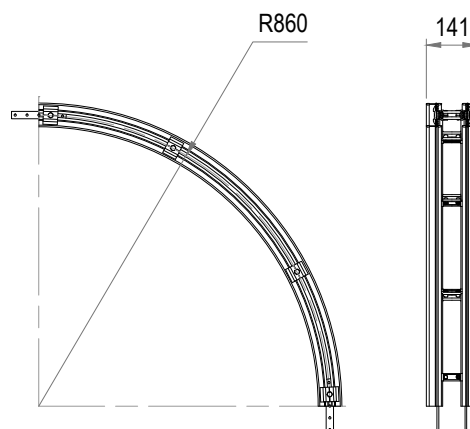

140-5695

VERTIKALKURVA X° SERIE 140
VERTICAL BEND X° SERIE 140
VERTIKALBOGEN X° SERIE 140

